

DI GROOVED FITTINGS-45° ELBOW

Type: 120

Doc No: DS-400-120-01-E

1.0 PRODUCT OVERVIEW

The 45° elbow is used for groove pipeline connection, which is mainly in pipeline bends to change the direction of the pipeline. It connects two pipes of the same nominal diameter to turn 45 degree.



Dimensions:

1"(DN25)– 24"(DN600)

Design Standard:

ISO6182, AWWA C606, GB 5135.11

Connection Standard:

ASME B36.10, ASTM A53-A53M, ISO 4200

Working Pressure:

175PSI-500PSI

Application:

The 45° elbow is suitable for medium and low pressure pipeline systems with nominal pressure 175-500 PSI, nominal size DN25-DN600, temperature range of -20 °C-+180°C, which are widely applied in water supply and drainage, fire-fighting, air conditioning, etc.

Pipe Material:

Welded and seamless rolled steel pipes according to ASME B36.10, ASTM A53-A53M, ISO 4200, GB/T 21835

Surface Treatment:

Sign Off:

Owner: _____ Contractor: _____

Engineer: _____

Location: _____ Date: _____

Approved & Date: _____

- Electrophoretic painting
- Epoxy power painting
- Hot-dip galvanizing
- Black
- Others would be available upon clients' detailed request

2.0 APPROVALS



3.0 SPECIFICATIONS-MATERIAL

ASTM A536, Ductile iron according to 65-45-12. The nodularity is more than 90%, ensuring excellent physical and mechanical properties.

4.0 DIMENSIONS AND PERFORMANCE

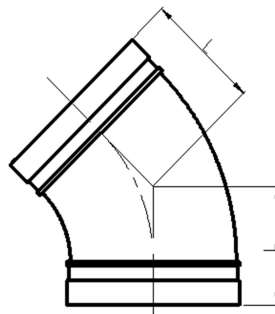

Nominal Size	Pipe O.D	Working Pressure	Dimensions L	Nominal Size	Pipe O.D	Working Pressure	Dimensions L
mm/in	mm/in	PSI/MPa	mm/in	mm/in	mm/in	PSI/MPa	mm/in

Sign Off:

Owner: _____ Contractor: _____
 Location: _____ Date: _____

Engineer: _____
 Approved & Date: _____

25	33.7	500	44.5	150	168.3	500	89
1	1.327	3.45	1.75	6	6.626	3.45	3.50
32	42.4	500	44.5	200	216.3	300	108
1¼	1.669	3.45	1.75	8	8.516	2.07	4.25
40	48.3	500	44.5	200	219.1	500	108
1½	1.902	3.45	1.75	8	8.626	3.45	4.25
50	60.3	500	51	250	267.4	300	120.5
2	2.374	3.45	2.01	10	10.528	2.07	4.75
65	73	500	57	250	273	500	120.5
2½	2.874	3.45	2.24	10	10.748	3.45	4.75
65	76.1	500	57	300	318.5	300	133
2½	2.996	3.45	2.24	12	12.539	2.07	5.24
80	88.9	500	63.5	300	323.9	500	133
3	3.500	3.45	2.50	12	12.752	3.45	5.24
100	108	500	76	350	377	300	122
4	4.252	3.45	2.99	14	14.843	2.07	4.80
100	114.3	500	76	350	355.6	300	152
4	4.500	3.45	2.99	14	14.000	2.07	5.98
125	133	500	82.5	400	406.4	300	184
5	5.236	3.45	3.25	16	16.000	2.07	7.24
125	139.7	500	82.5	450	457.2	300	203
5	5.500	3.45	3.25	18	18.000	2.07	7.99
125	141.3	500	82.5	500	508	300	229
5	5.563	3.45	3.25	20	20.000	2.07	9.02
150	159	500	89	600	609.6	300	280
6	6.260	3.45	3.50	24	24.000	2.07	11.02
150	165.1	500	89				
6	6.500	3.45	3.50				

5.0 REFERENCE MATERIALS

Approved certification for Grooved Fittings and Couplings

I-JM-Grooved fitting: Installation Instructions for grooved fittings and couplings

Sign Off:

Owner: _____ Contractor: _____

Location: _____ Date: _____

Engineer: _____

Approved & Date: _____